



PRIVACY PANEL INSTALLATION



Scan QR code for
video tutorial



1. EACH KIT INCLUDES:
ONE PANEL, TWO BRACKETS
AND ONE WRENCH.



2. LOOSEN THE TOP SCREWS
ON BOTH BRACKETS.



3. PLACE THE FIRST BRACKET
OVER THE CUBICLE'S EDGE, ABOUT
A HAND LENGTH AWAY FROM
THE END OF YOUR CUBICLE.

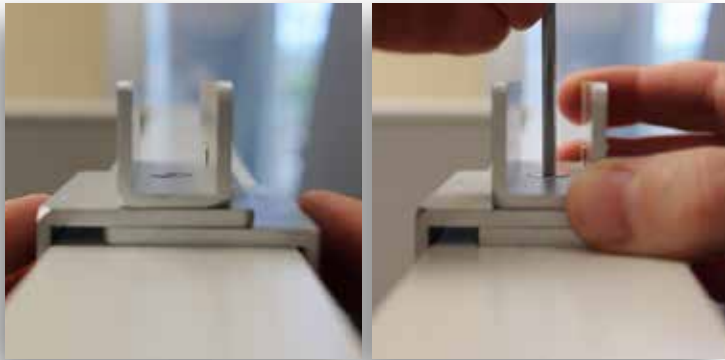

4. SQUEEZE BRACKET AND CENTER TOP U-CHANNEL. TIGHTEN THE TOP SCREW WITH WRENCH.



5. REPEAT STEPS 3-4 FOR SECOND BRACKET.



6. PLACE PANEL INTO U-CHANNELS.



7. TIGHTEN THE SCREWS IN U-CHANNELS TO SECURE PANEL IN PLACE.



8. YOUR PRIVACY PANEL IS NOW INSTALLED.



Scan QR code for
video tutorial