

PARTS

A X 2



B X 4



C X 8



D X 2



E X 2



F X 4



G X 4



H X 2



J X 4



K X 4



L X 4



ALLEN
WRENCH



YOU WILL NEED:



PHILLIPS HEAD SCREW DRIVER

1. Locate the pre-drilled screw holes on the sides and the bottom of the panel.

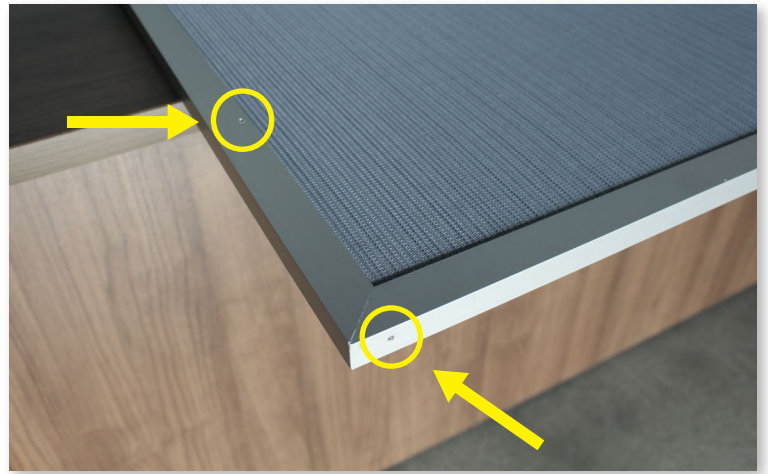

2. Take L-Brackets (K) and place on plate (H). Leave one hole open at the end of H. Use allen wrench to loosely screw in C. Repeat on other side plate.

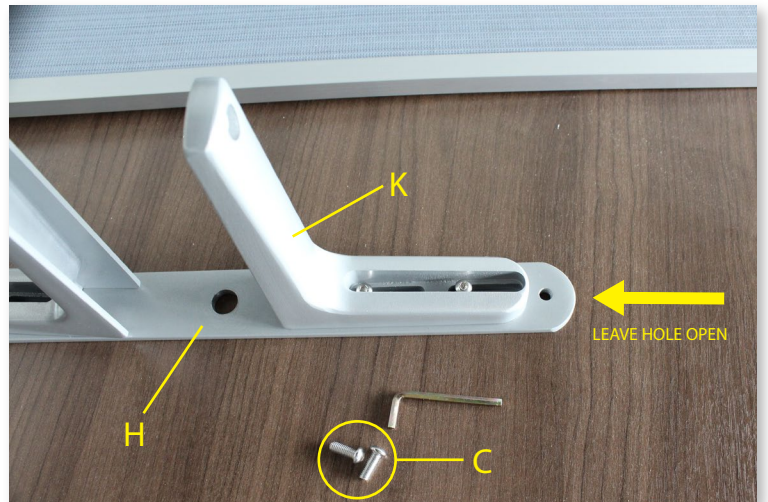

3. Once all 4 L-Brackets (K) are attached to both plates (H) place brackets over panel.



Squeeze L-brackets (K) and tighten all 8 screws (C) with allen wrench.

4. Use the 4 silver screws (B) to secure the L-Brackets (K) to the panel on both sides.

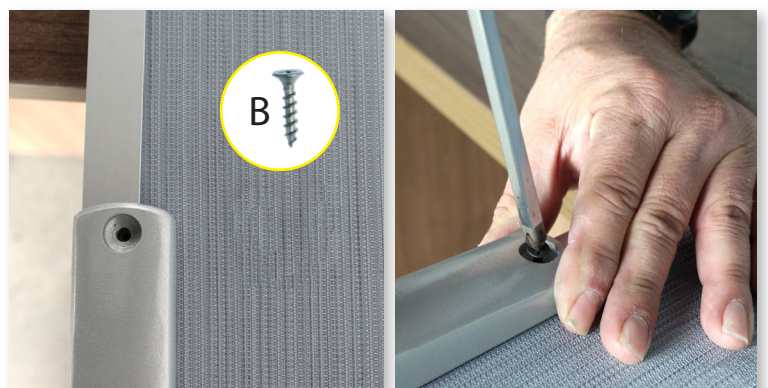

5. Using a screw driver and parts A, D & E screw in plate (H) to bottom hole in panel.

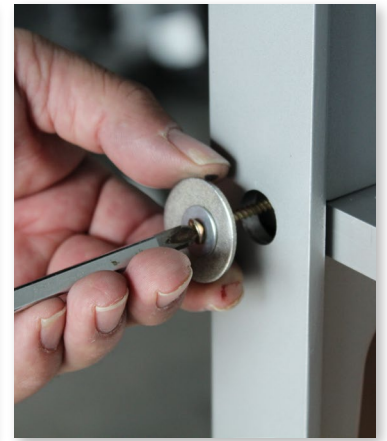
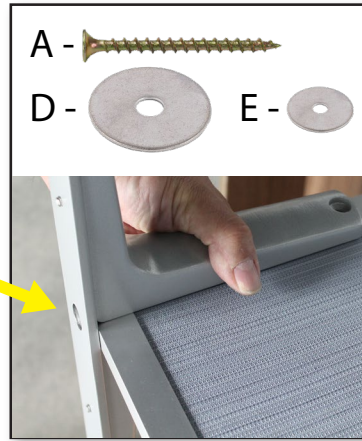

6. Once H and K are attached to the panel, screw in casters (F) to each side of bottom plate (H). Screw in caps (G) to secure casters.

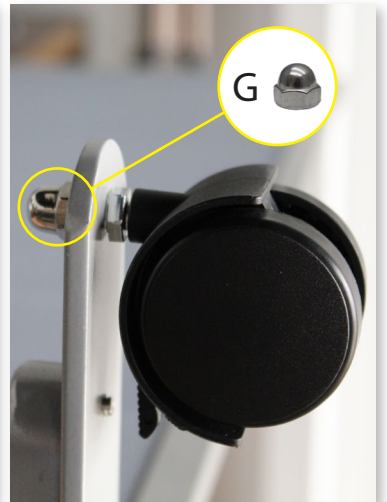

7. Take parts L and J to cover screw holes. when placing L make sure the longer edge is closest to the panel.

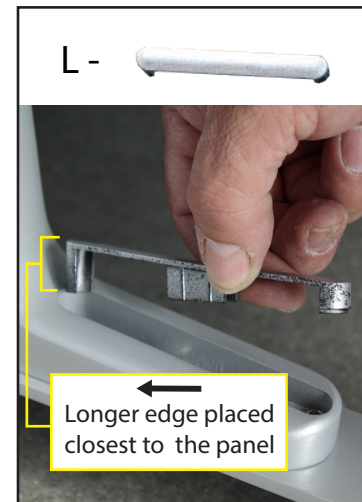

8. Once all screw holes are covered, your panel will be complete and ready to use!

